

ROOMS A/B/C

When combined, Rooms A, B and C can accommodate up to 2'500 participants. The rooms can be separated in 30 minutes using mobile partition walls enabling an optimum sound insulation for up to three parallel sessions.

Cocktails, coffee breaks, receptions or displays can be held in the foyer in front of the rooms.

Features

■ area (m ²)	2'300
■ length (m)	66.50
■ width (m)	32.00
■ useable height (m)	5.50
■ capacity (persons)	2'500

Combination and subdivision

- combined A/B/C, maximum capacity: 2'500 seats, theatre-style
- combined A/B or B/C, maximum capacity per room: 1'500 seats, theatre-style
- separated A, B or C, maximum capacity per room: 2 x 800 and 1 x 650 seats, theatre-style

Included in rental charge

- set-up in theatre style, head table, speaker's lectern
- projection screen 5.0 x 4.0 m
- sound system with 1 cable microphone on lectern
- 14 interpreter booths (equipment rental not included)
- free WiFi access
- general lighting
- heating, ventilation, air conditioning
- daily cleaning
- existing digital screens at room entrances
- personalised signage on

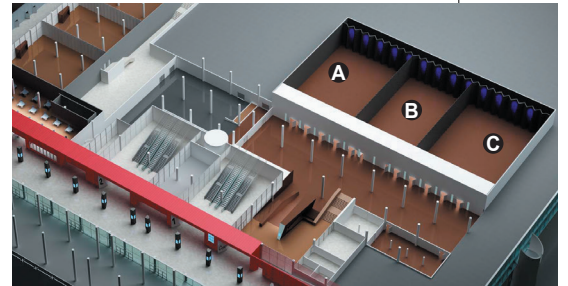
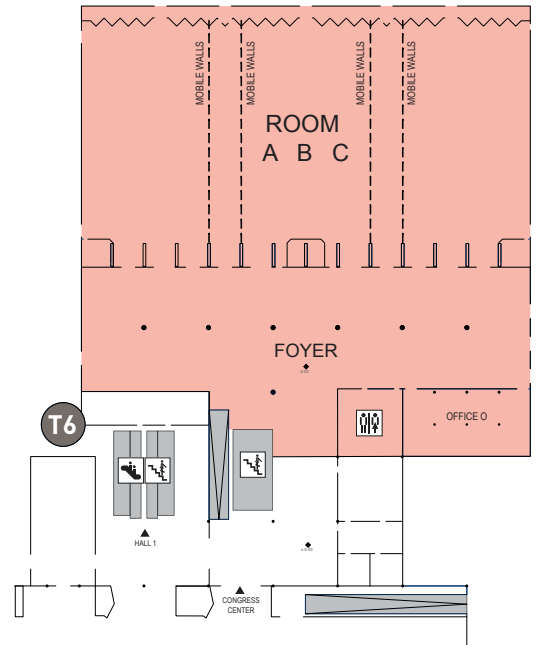

Available upon request

Simultaneous interpretation system, A/V equipment, additional microphones, special lighting, audio/video recording and distribution, room interconnection, video and computer projection, video-conferencing, closed-circuit TV, Internet access, satellite hookup, possibility of satellite broadcasting, fixed rigging points available

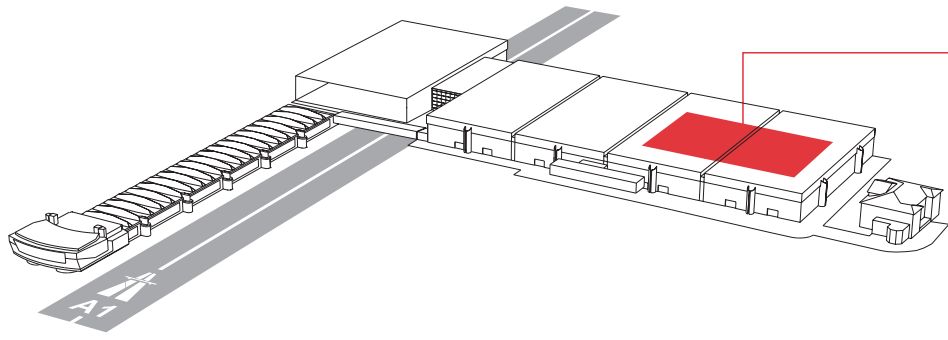

CONFERENCE FACILITIES

PALEXPO features 16 meeting rooms with a total capacity of 5'000 seats. Participants also be seated in conference rooms can be built within the exhibition halls. All rooms are linked by fiber optic cable, 100 Mbps copper and cable TV networks.

	AREA (m ²)	THEATRE STYLE (persons)	WIDTH (m)	LENGHT (m)	USEABLE HEIGHT (m)	FLOOR LOADING Kg/m ²
Conference centre						
Room A small	640	650	18.80	32.00	5.50	400
Room A large	830	800	23.60	32.00	5.50	400
Room B small	640	650	19.10	32.00	5.50	400
Room B medium	830	800	23.90	32.00	5.50	400
Room B large	1'020	1000	28.70	32.00	5.50	400
Room C small	640	650	18.80	32.00	5.50	400
Room C large	830	800	23.60	32.00	5.50	400
Room A+B/B+C	1'470	1'500	42.80	32.00	5.50	400
Room A+B/B+C large	1'660	1'700	47.60	32.00	5.50	400
Room A+B+C	2'300	2'500	66.50	32.00	5.50	400
Room E	130	120	9.30	13.90	3.00	400
Room F	130	120	9.30	13.90	3.00	400
Room G	130	120	9.30	13.90	3.00	400
Room K	240	230	14.15	16.70	3.00	400
Room L	140	100	11.90	10.70	3.00	400
Lobby ABC	1'350	also available for cocktails/receptions or exhibitions			2.95	400
Lobby EFGKL	800	also available for cocktails/reception or exhibitions			3.00	400

Please note: total capacity of rooms ABC when used together does not equal the sum of individual room capacity listed above